



- 2000 hours at +150°C
- Low ESR
- High ripple current capability
- High vibration stability
- AEC-Q200 automotive qualified, RoHS Compliant

CDC 126 LT

Items	Characteristics		
Operating Temperature Range (°C)	-40 ~ +150		
Voltage Range (V)	25 ~ 63		
Capacitance Range (μF)	250 ~ 4000		
Capacitance Tolerance (20°C,100Hz)	-10/+30%,(± 20% select values)		
Leakage Current (μA)	After 5 minutes at 20°C application of rated voltage, leakage current is not more than 0.003CV+4.0 . C: Nominal Capacitance(μF) V: Rated Voltage(V)		
Equivalent Series Resistance (20°C, 100Hz/100kHz)	Less than values shown in the standard ratings.		
Load Life	Ripple Current: Maximum ripple current specified in the standard ratings. Voltage: The sum of DC voltage and the peak AC voltage must not exceed the rated voltage of capacitor.		
	D(mm)	+125°C Life Time (hours)	+150°C Life Time (hours)
	16	6300	1500
	20	8400	2000
	Capacitance Change: Within 15% of the initial value. Equivalent Series Resistance: Not more than 200% of the initial value. Leakage Current: Not more than the initial specified value. (All specifications should be test at +20°C Life ambient temperature.)		
Shelf Life	5000 hours at +105°C or 10 years at +40°C 0 VDC		
Vibration Test	Procedure: Displacement amplitude max.1.5mm, acceleration max.20 g, duration 3×2h, frequency range 10 ~ 2000 Hz (capacitor clamped by body). Requirements: No leakage of electrolyte or other visible damage. Deviations in capacitance from initial value must not exceed $\Delta C/C < 5\%$.		
Standards	IEC 60384-4, AEC-Q200		

AXIAL/CROWN

Dimensions mm

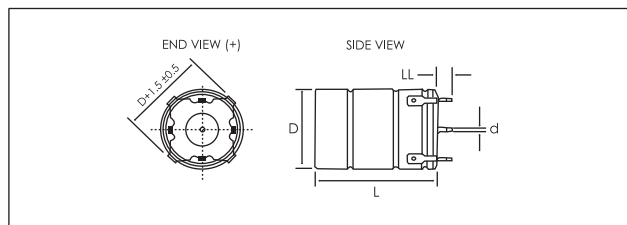

Dimension Code	D	L	d	LL	Approximate Weight (g)
	±0.5	±1.0	±0.03	±0.5	
160031	16.0	31.0	1.0	3.3	8
160039	16.0	39.0	1.0	3.3	11
200031	20.0	31.0	1.0	3.3	13
200039	20.0	39.0	1.0	3.3	20
200048	20.0	48.0	1.0	3.3	24

Note: L1 is Jianghai's recommendation for minimum distance between symmetrical lead bend.

Part Number System (Ex:40V1000μF)

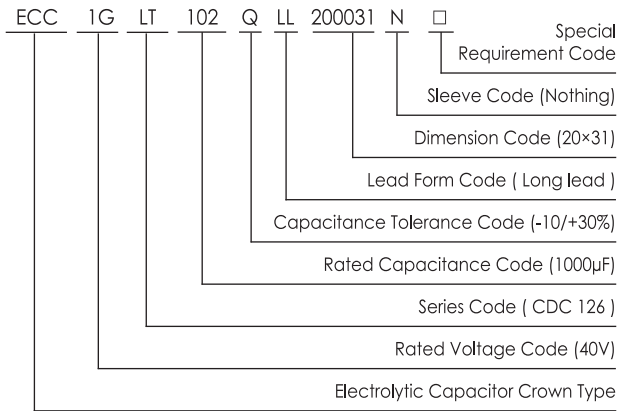

Ripple Current Coefficient

Frequency (Hz)	300	1K	5K	100K
Coefficient	0.57	0.80	1.00	1.04

Ratings for CDC 126 Series

U _r Code	Rated Capacitance	Max ESR			Max Ripple Current				ESL	Size ΦD x L	P/N
		20°C, 100Hz	20°C, 100Hz	20°C, 100kHz	125°C, 100Hz	105°C, ≥5kHz	125°C, ≥5kHz	150°C, ≥5kHz			
(V)	(μF)	(mΩ)	(mΩ)	(Arms)	(Arms)	(Arms)	(Arms)	(nH)	(mm)	-	
25 (1E)	1000	80	28	1.7	8.8	5.2	2.0	12	16x39	ECC1ELT102Q □□ 160039	
	1500	63	26	2.1	9.2	5.4	2.1	12	16x39	ECC1ELT152Q □□ 160039	
	2200	51	25	2.5	9.4	5.5	2.1	12	20x31	ECC1ELT222Q □□ 200031	
	3300	34	17	3.2	11.7	6.9	2.6	15	20x39	ECC1ELT332Q □□ 200039	
	4000	29	14	3.7	13.1	7.7	2.9	17	20x48	ECC1ELT402M □□ 200048	
40 (1G)	470	150	45	1.1	5.9	3.5	1.3	10	16x31	ECC1GLT471Q □□ 160031	
	600	120	30	1.4	8.3	4.9	1.9	12	16x39	ECC1GLT601Q □□ 160039	
	1000	75	23	1.9	9.4	5.5	2.1	12	20x31	ECC1GLT102Q □□ 200031	
	1500	58	22	2.2	9.7	5.7	2.2	12	20x31	ECC1GLT152Q □□ 200031	
	2200	43	18	2.8	11.4	6.7	2.6	15	20x39	ECC1GLT222Q □□ 200039	
	2700	37	17	3.1	12.1	7.1	2.7	17	20x48	ECC1GLT272Q □□ 200048	
63 (1J)	250	240	53	0.9	5.3	3.1	1.2	10	16x31	ECC1JLT251Q □□ 160031	
	370	160	37	1.2	6.7	3.9	1.5	12	16x39	ECC1JLT371Q □□ 160039	
	470	130	32	1.4	7.3	4.3	1.6	12	20x31	ECC1JLT471Q □□ 200031	
	680	90	23	1.7	9.0	5.3	2.0	15	20x39	ECC1JLT681Q □□ 200039	
	900	69	18	2.1	10.5	6.1	2.3	17	20x48	ECC1JLT901Q □□ 200048	

AXIAL/CROWN